

**#3654**

**ANT\_Window\_Tetra\_ISM\_3G\_Bluetooth\_WiFi\_SMA(m)**

<b>Type</b>	Patch antenna
<b>Frequencies</b>	AMPS (824-894 MHz) ISM (868 MHz) GSM (900 MHz) DCS (1800 MHz) PCS (1900 MHz) 3G (UMTS 2.1 GHz) WIFI / BLUETOOTH (2.4 GHz) WIFI (5.0 GHz)
<b>Mounting</b>	Embedded/Patch Mount
<b>Revision</b>	00

**Application**

Mobile applications  
Wireless applications  
Smart meters



# 1. SPECIFICATION

## 1.1. Electrical Specifications

Frequencies	AMPS (824-894 MHz) ISM (868 MHz) GSM (900 MHz) DCS (1800 MHz) PCS (1900 MHz) 3G (UMTS 2.1 GHz) WIFI / BLUETOOTH (2.4 GHz) WIFI (5.0 GHz)
Impedance	50 Ohms
Polarization	Vertical
Gain	2.2 dBi
VSWR	<2:1
Power handling	35W
Operating temperature	-40°C to +85°C

## 1.2. Connection Specifications

- Cable type and connector are upon request.
- Minimum cable length what is suitable for this antenna is 30cm

## 1.3. Mechanical Specifications and Dimensions

### 1.3.1. Glass mount

Max. dimensions: 116mm x 6.7mm x 22mm  
 Weight: 17 g 'weight with 30cm cable length and SMA connector'  
 Colour: Black solder mask on bottom side of PCB

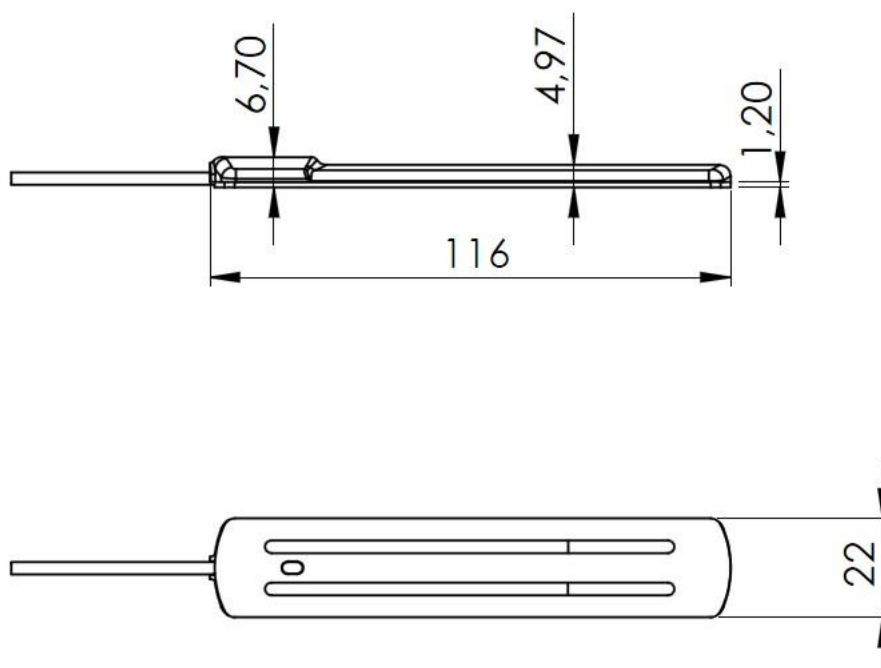

## 2. MEASUREMENT

Log Mag (WiFi 5GHz)

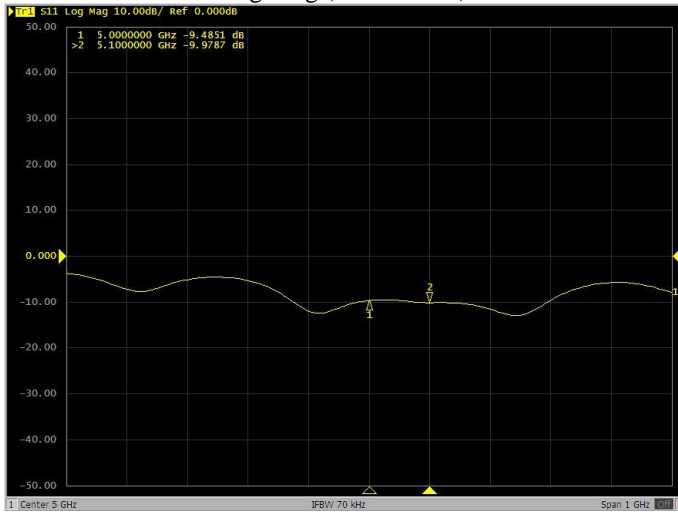

Tested with 30cm cable length

Log Mag (Quad Band + WiFi)

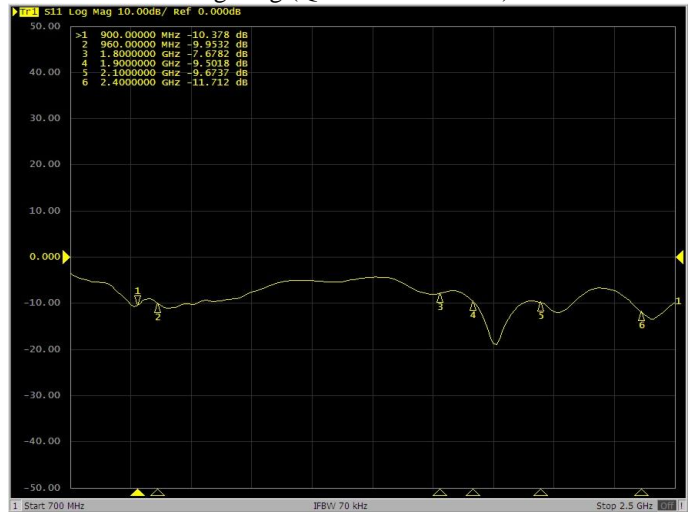

Tested with 30cm cable length

VSWR (WiFi 5GHz)

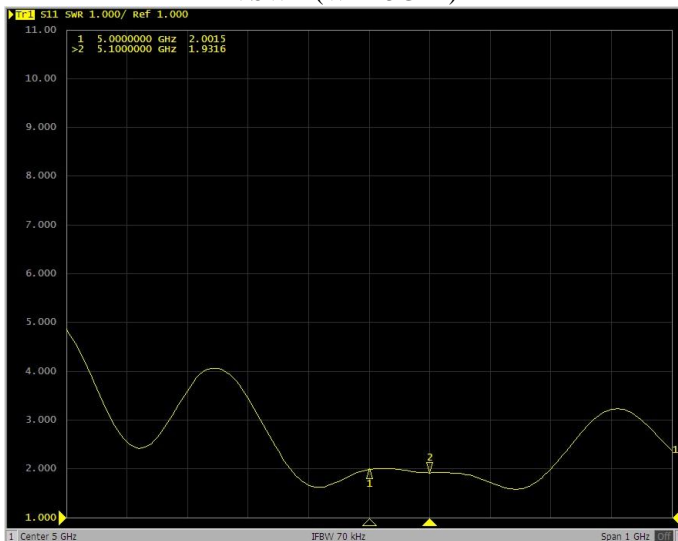

Tested with 30cm cable length

VSWR (Quad Band + WiFi)

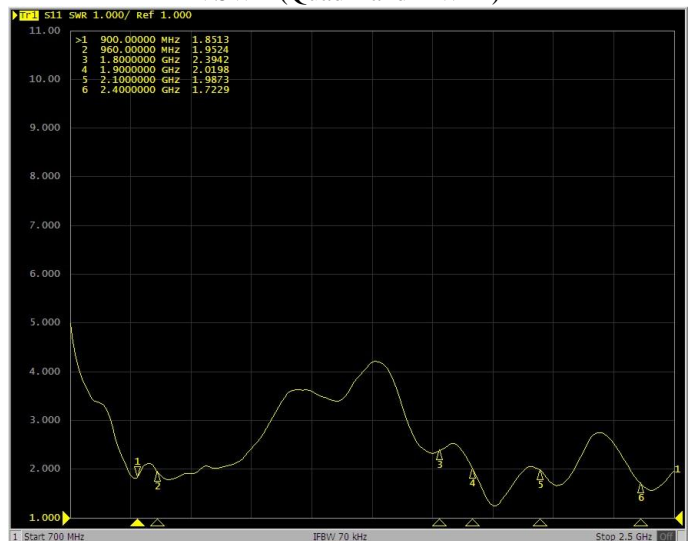

Tested with 30cm cable length

Log Mag (WiFi 5GHz)

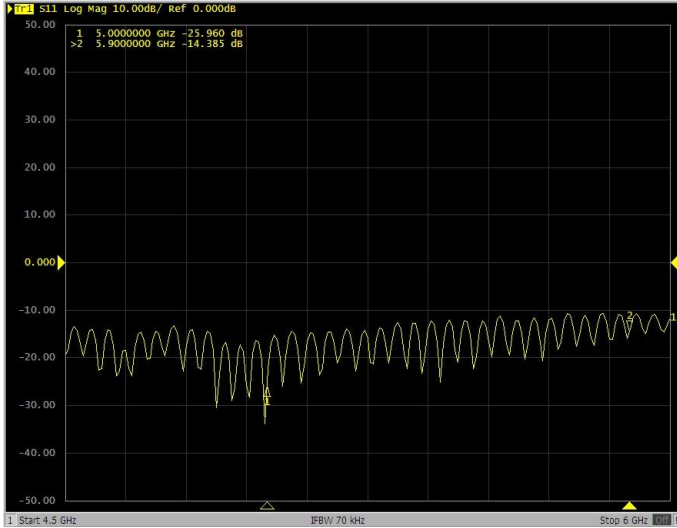

Tested with 2.5m cable length

Log Mag (Quad Band + WiFi)

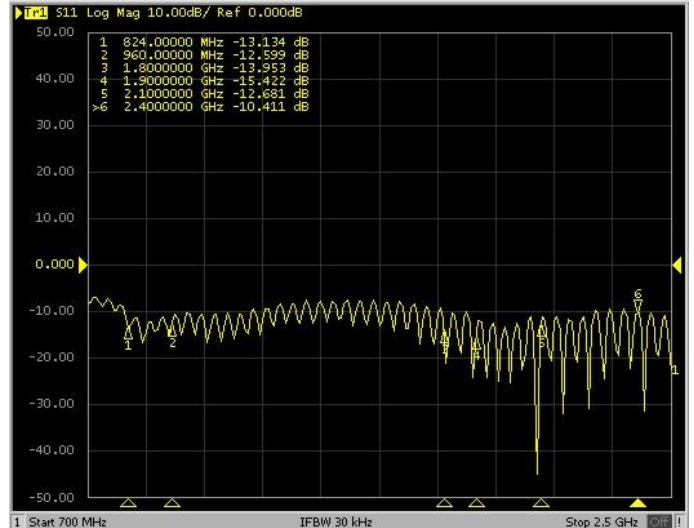

Tested with 2.5m cable length

VSWR (WiFi 5GHz)

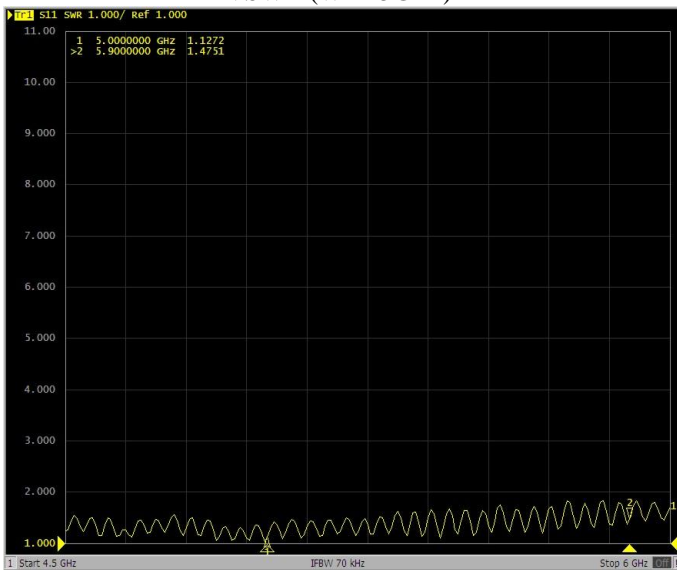

Tested with 2.5m cable length

VSWR (Quad Band + WiFi)

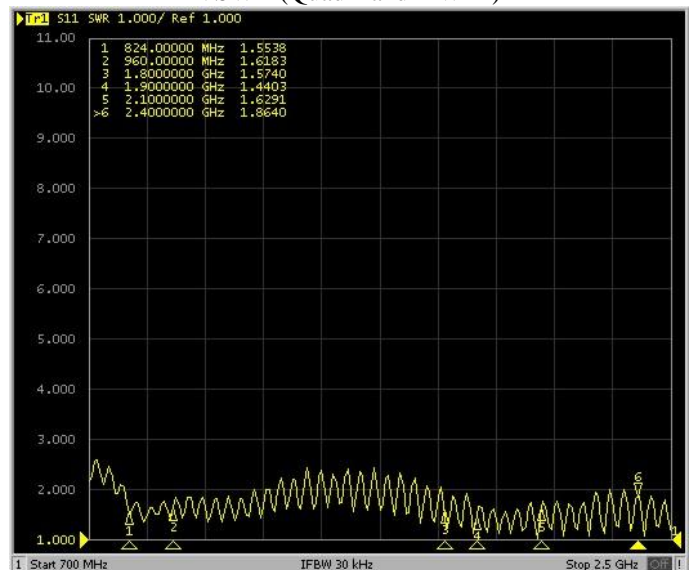

Tested with 2.5m cable length